



Oakfield Road

Harpenden, AL5 2NL

Beautifully presented family home arranged over three floors, measuring in excess of 3,600 square feet. On a 0.17 acre with a west facing garden of 65 feet and double garage. Oakfield Road is a peaceful spot in the heart of the much sought after West Common area. Close to Rothamsted Estate and within a short drive of Harpenden town centre and station.

Price guide £2,250,000

Oakfield Road

Harpenden, AL5 2NL



- Fantastic family home of over 3,600 square feet
- 65 feet west facing garden
- Within a short drive of Harpenden town centre and station.
- Arranged over three floors
- Double Garage
- Plot of 0.17 acre
- Close to Rothamsted Estate

Entrance Hall

Cloakroom

Utility Room

11'6" x 6'10" (3.52m x 2.09m)

Kitchen/Breakfast Room

20'2" x 13'9" (6.15m x 4.20m)

Dining Room

16'2" x 11'11" (4.95m x 3.65m)

Family Room

20'2" x 15'3" (6.15m x 4.67m)

Bedroom One

16'1" x 13'11" (4.92m x 4.26m)

En-Suite Bathroom

Bedroom Two

18'9" x 16'9" (5.73m x 5.12m)

En-Suite Shower Room

Living Room

20'2" x 17'4" (6.15m x 5.29m)

Study

12'8" x 7'9" (3.88m x 2.37m)

Bedroom Three

16'9" x 15'11" (5.12m x 4.86m)

En-Suite Shower Room

Bedroom Four

14'1" x 13'7" (4.30m x 4.16m)

Bedroom Five

10'10" x 10'9" (3.31m x 3.30m)

Bathroom

Garage

19'7" x 18'1" (5.97m x 5.515m)

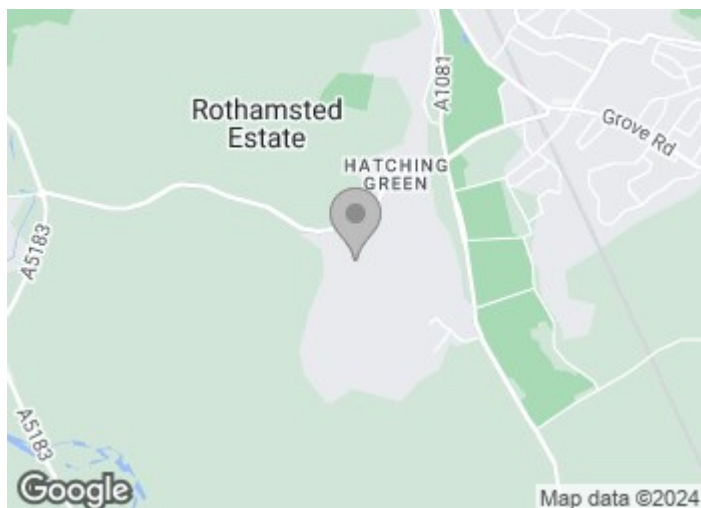



Floor Plan

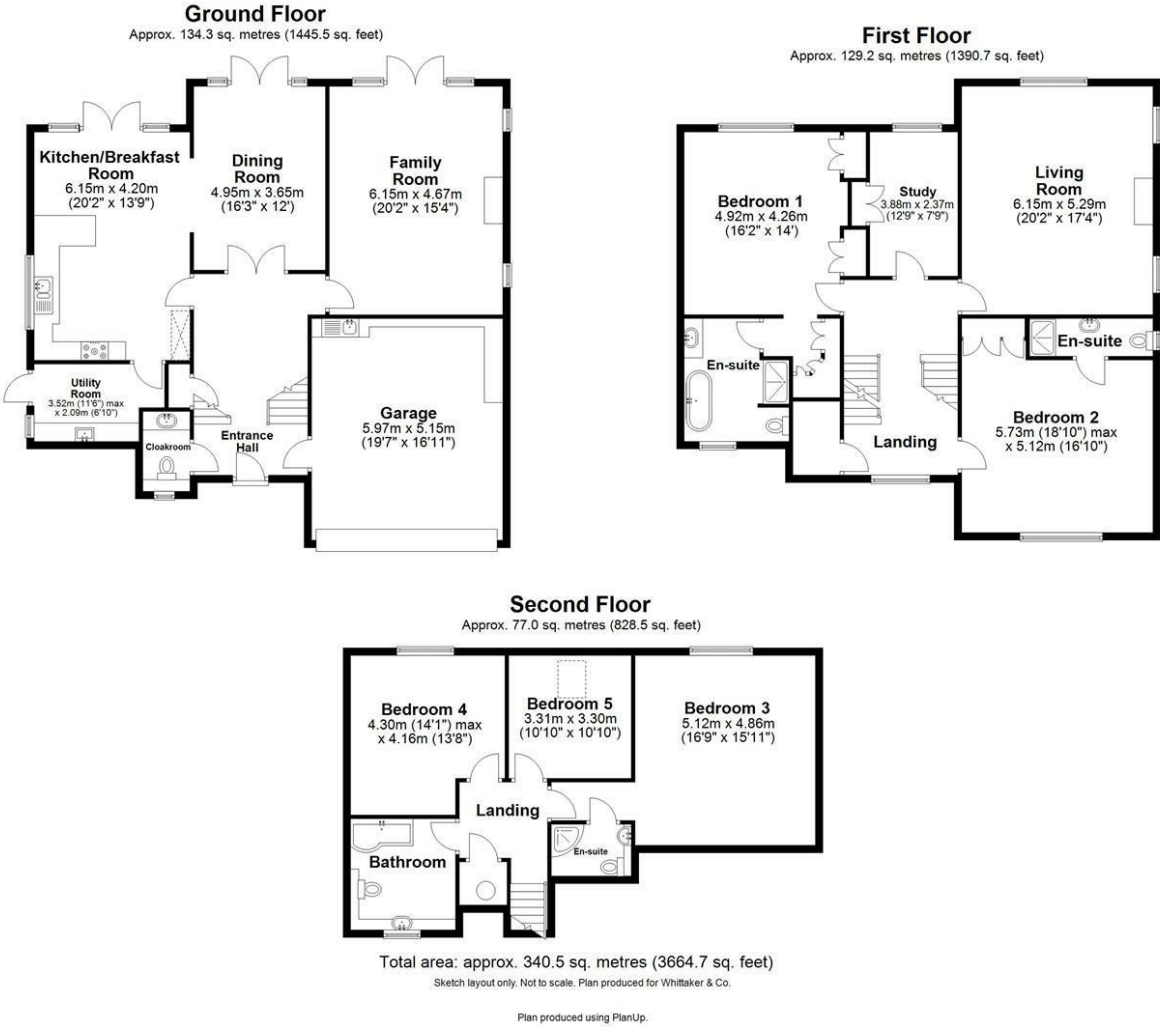

These particulars, whilst believed to be accurate are set out as a general outline only for guidance and do not constitute any part of an offer or contract. Intending purchasers should not rely on them as statements of representation of fact, but must satisfy themselves by inspection or otherwise as to their accuracy. No person in this firms employment has the authority to make or give any representation or warranty in respect of the property.

